

CMV IgM Rapid Test Cassette (Serum/Plasma)

DIRECTIONS FOR USE

For Serum or Plasma specimen:

- Transfer 1 full drop (approx. 20 μ L) of specimen to each sample well, then add 2 drops of buffer (approximately 80 μ L) to each sample well and start the timer.

-**Note** :Wait for the colored line(s) to appear. The result should be read at 15 minutes. Do not interpret results after 20 minutes.

Note: It is suggested do not use the buffer which open the cap for 30 days.

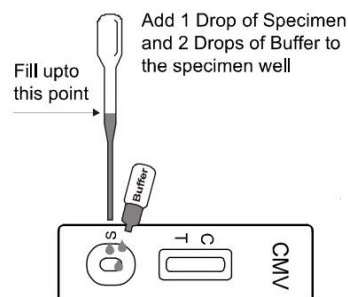

INTERPRETATION OF RESULTS

POSITIVE: * **Two colored lines appear.** One colored line should always appear in the control line region (C) and another line should be in the test line region.

***NOTE:** The intensity of the color in the test line regions may vary depending on the concentration of CMV antibodies present in the specimen. Therefore, any shade of color in the test line region should be considered positive.

NEGATIVE: **One colored line appears in the control line region (C).** No line appears in the test line regions.

INVALID: **Control line fails to appear.** Insufficient specimen volume or incorrect procedural techniques are the most likely reasons for control line failure. Review the procedure and repeat the test with a new test.

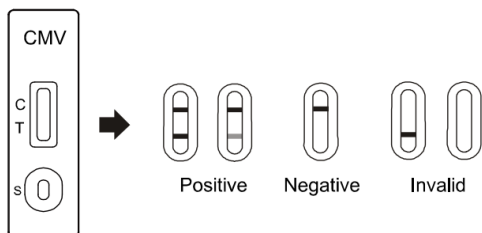

PRECAUTIONS

-This package insert must be read completely before performing the test. Failure to follow directions in insert may yield inaccurate test results.

-For professional in vitro diagnostic use only.

-Do not use after expiration date.

-Wear protective clothing such as laboratory coats, disposable gloves, and eye protection when specimens are assayed.

-Please ensure that an appropriate quantity of sample volumes are used for testing. Too much or too little sample size may lead to deviation of results.

-The used test should be discarded according to local regulations.

STORAGE AND STABILITY

Store as packaged in the sealed pouch at room temperature or refrigerated (2-30°C). The test is stable through the expiration date printed on the sealed pouch. The test must remain in the sealed pouch until use.

DO NOT FREEZE. Do not use beyond the expiration date.